

7 Sun Shades MK: 11SS1
9/53.1 A2.0 Per Window Type R

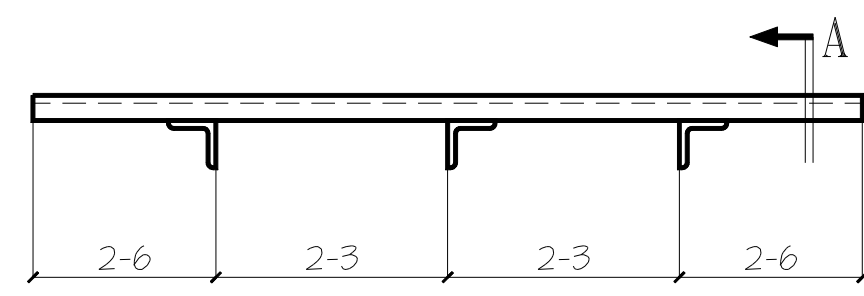

2 Sun Shades MK: 11SS2
9/53.1 A2.0 Per Window Type H

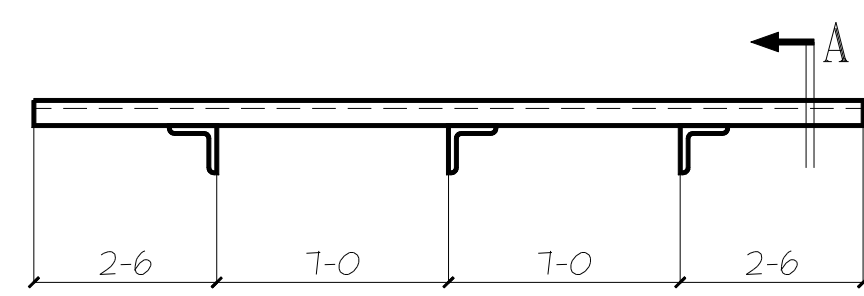

1 Sun Shades MK: 11SS3
9/53.1 A2.0 Per Window Type P

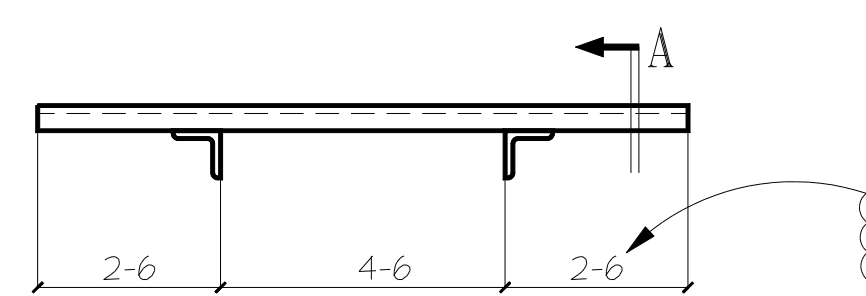

1 Sun Shades MK: 11SS4
9/53.1 A2.0 Per Window Type O

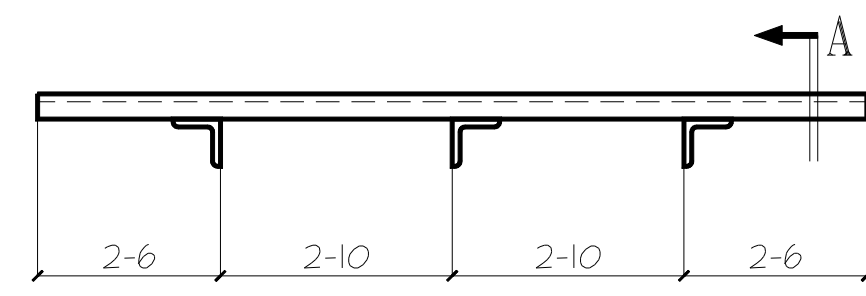

3 Sun Shades MK: 11SS5
9/53.1 A2.0 Per Window Type U

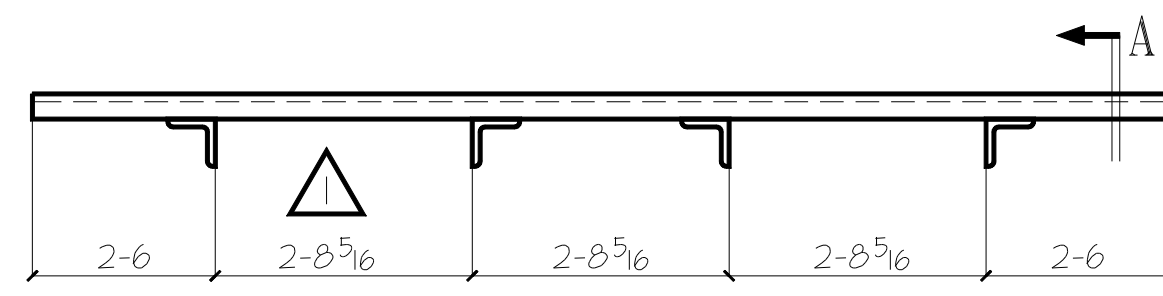

1 Sun Shades MK: 11SS6
9/53.1 A2.0 Per Window Type T

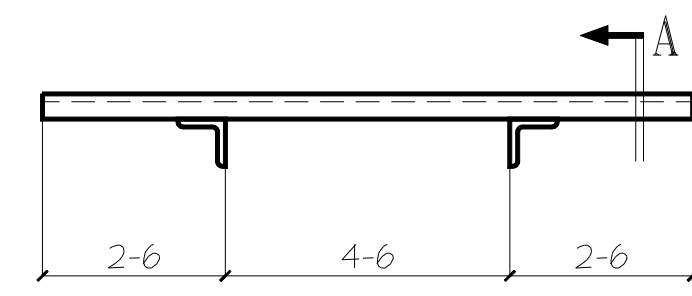

2 Sun Shades MK: 11SS7
9/53.1 A2.0 Per Window Type S

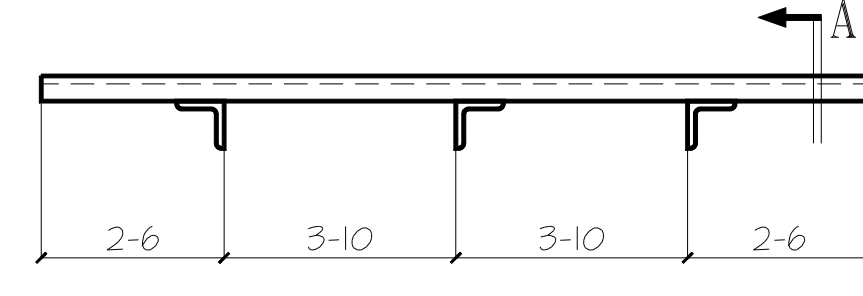

2 Sun Shades MK: 11SS8
9/53.1 A2.0 Per Window Type I

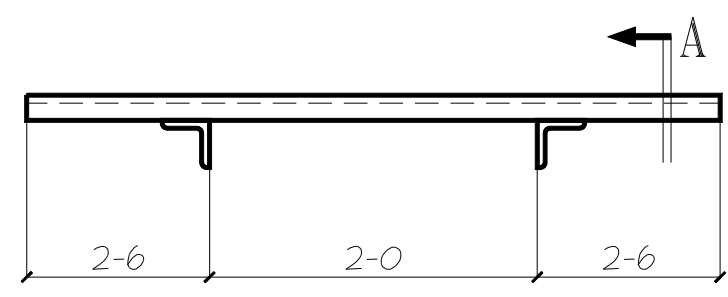

1 Sun Shades MK: 11SS9
9/53.1 A2.0 Per Window Type K

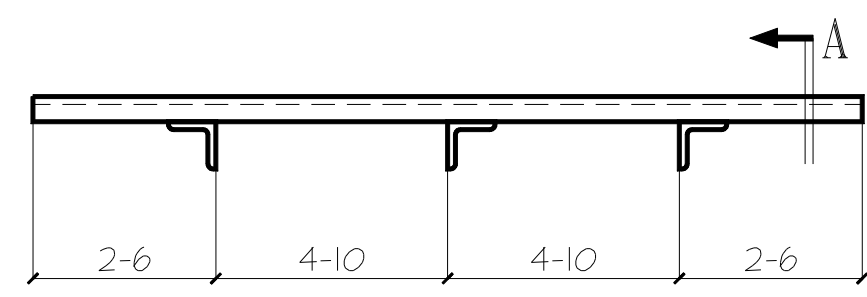

1 Sun Shades MK: 11SS10
9/53.1 A2.0 Per Window Type M

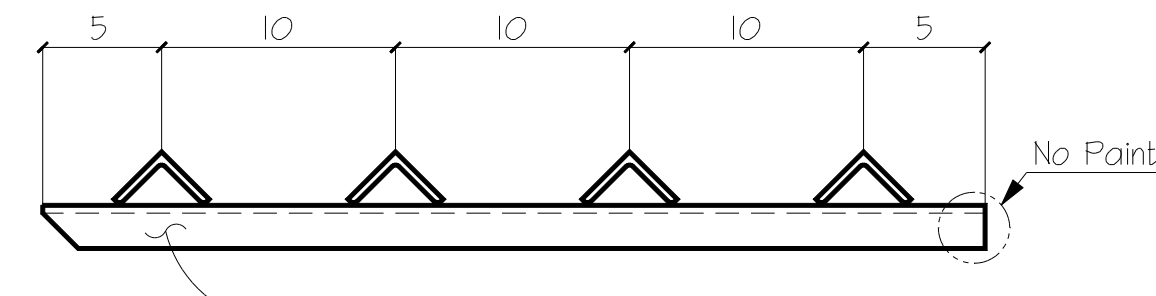

Section A

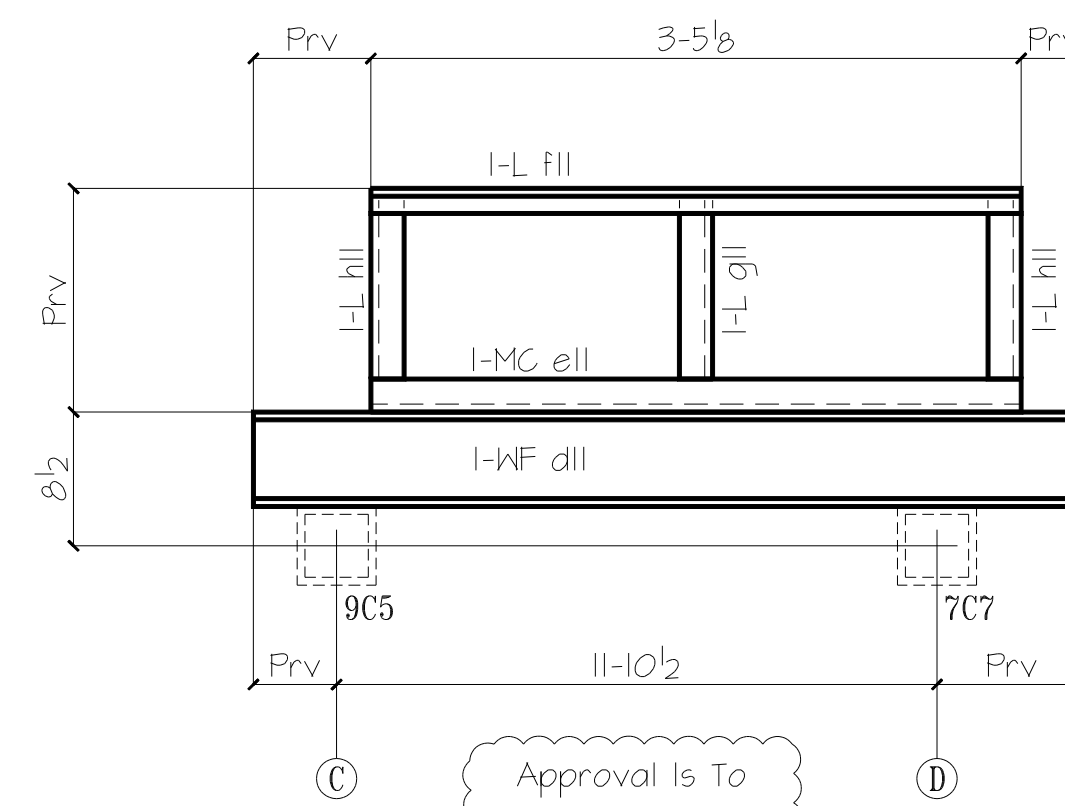

3 Sun Canopy MK: 11SC1
Ref 7/53.1

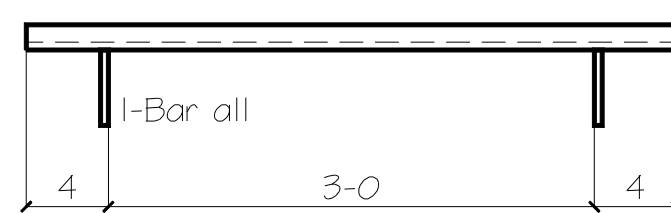

7 Shades Brackets MK: 11SB1
Per Sun Shades 11SS1

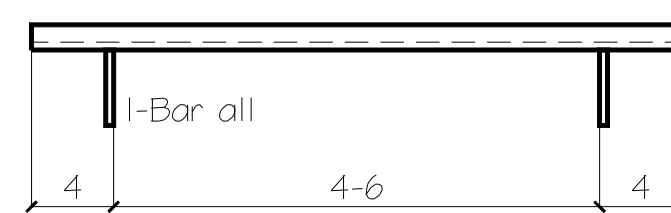

5 Shades Brackets MK: 11SB2
Per Sun Shades 11SS2, 4 & 7

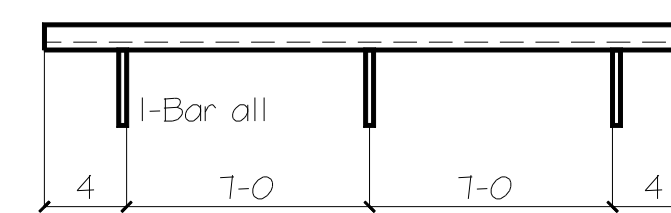

1 Shades Brackets MK: 11SB3
Per Sun Shades 11SS3

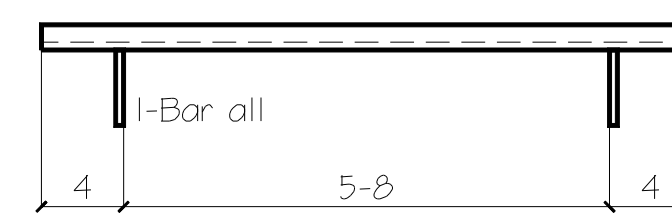

3 Shades Brackets MK: 11SB4
Per Sun Shades 11SS5

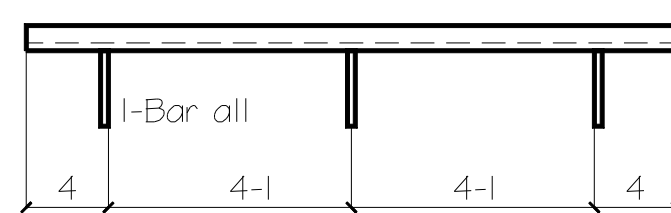

1 Shades Brackets MK: 11SB5
Per Sun Shades 11SS6

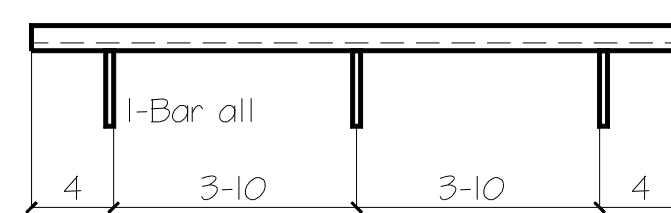

2 Shades Brackets MK: 11SB6
Per Sun Shades 11SS8

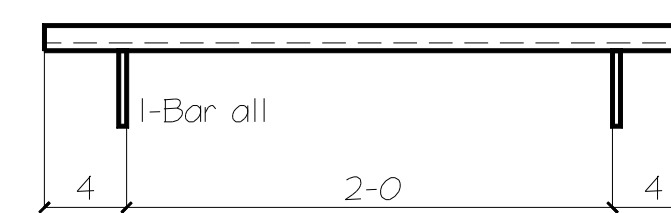

1 Shades Brackets MK: 11SB7
Per Sun Shades 11SS9

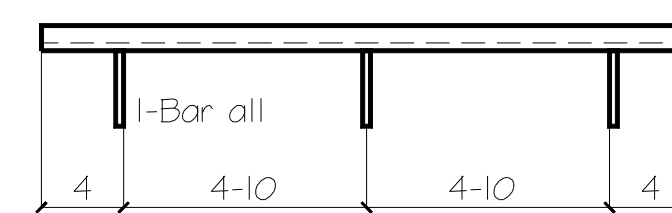

1 Shades Brackets MK: 11SB8
Per Sun Shades 11SS10

- BILL OF MATERIAL -						INSPECTION	
SHIP MK	TEMP MK	QTY	DESCRIPTION	LENGTH	REMARKS	WELDER	FINALE
11551		7	Sun Shade				
	sall	28	L 3 x 3 x 1/4	8-0			
11552		2	Sun Shade				
	sbl	8	L 3 x 3 x 1/4	9-6			
11553		1	Sun Shade				
	scl	4	L 3 x 3 x 1/4	19-0			
11554		1	Sun Shade				
	sdll	4	L 3 x 3 x 1/4	9-6			
11555		3	Sun Shade				
	sell	12	L 3 x 3 x 1/4	10-8			
11556		1	Sun Shade				
	sdll	4	L 3 x 3 x 1/4	13-1			
11557		2	Sun Shade				
	sell	8	L 3 x 3 x 1/4	9-6			
11558		2	Sun Shade				
	sfil	8	L 3 x 3 x 1/4	12-8			
11559		1	Sun Shade				
	sgll	4	L 3 x 3 x 1/4	7-0			
115510		1	Sun Shade				
	shll	4	L 3 x 3 x 1/4	14-8			
	ssll	58	L 3 x 3 x 1/4	3-4	Per Sun Shade		
115C1		1	Sun Canopy		Ref 7/53.1		
	dll	1	W6x15	Prv			
	ell	1	MC12x10.6	Prv			
	fill	1	L 1 1/2 x 1 1/2 x 1/4	Prv			
	gll	1	L 3 x 3 x 1/4	Prv			
	hll	2	L 3 x 3 x 1/4	Prv			
115B1		7	MC12x10.6	3-8			
115B2		5	MC12x10.6	5-2			
115B3		1	MC12x10.6	14-8			
115B4		3	MC12x10.6	6-4			
115B5		1	MC12x10.6	8-10			
115B6		2	MC12x10.6	8-4			
115B7		1	MC12x10.6	2-8			
115B8		1	MC12x10.6	10-4			
	all	47	Bar 1/4 x 6	1-0	Per Brackets		

Useable Template Mark Letters
A-Z a-z 0-9
TSD File: Daypda_misc.dwg

- DESCRIPTION OF REVISIONS MADE TO DRAWING -				
1				
2				
3				
	REVISION DESCRIPTION	DATE	MADE BY	CHK BY
	REF DWG E5 & S2.2			

MATERIAL GRADE SHELL BE	A36	U.N.O.
WF SHAPES	A992	TUBES A500
CHANNELS	A992	PIPES A501 or A53
COATING	One 5/C Red Oxide Primer	
13/16" OPEN HOLE	1/4" FILLETS	E700XX ELECTRODES
APPROVAL	TO SHOP 5-18-08	

J&D Steel	
DETAILS OF Sun Shades	
CUSTOMER	Crownhill Builders Inc
ARCHITECT	DHR Durand Hollis Rupe
PROJECT	Whispering Waters Day Spa
LOCATION	13111 Heubner Rd
DETAIL	DY 4-16-08
CHK.R	MG 5-18-08
JOB #	8007
SHEET #	D11

Rev-1