

Useable Temple Mark Letters
 ///////////////ghjkmnpqrstvwyz

- DESCRIPTION OF REVISIONS MADE TO DRAWING -	
1	
2	
3	
4	
REF DWG	

- UNLESS NOTED OTHERWISE -	
1/4"	MATERIAL GRADE SHELL BE A36 U.N.O.
FILLETS	WF SHAPES A992 TUBES A500
13/16" Ø	CHANNELS A992 PIPEs A501 or A53
OPEN HOLE	REF SCHEDULE Item # SFI 5101
	COATING One S/G Red Oxide Primer

AWF

DETAILS OF Column 4 Handrails

PROJECT AT&T Science Facility

LOCATION ?

CUSTOMER Texas Lutheran University

ARCHITECT ?

ENGINEER ?

DETAIL DR 1-31-08

CHK.R

FN: atsc-stairs.dwg

SHOP CODE	SHEET #	REV #
AT&T Science	D4	

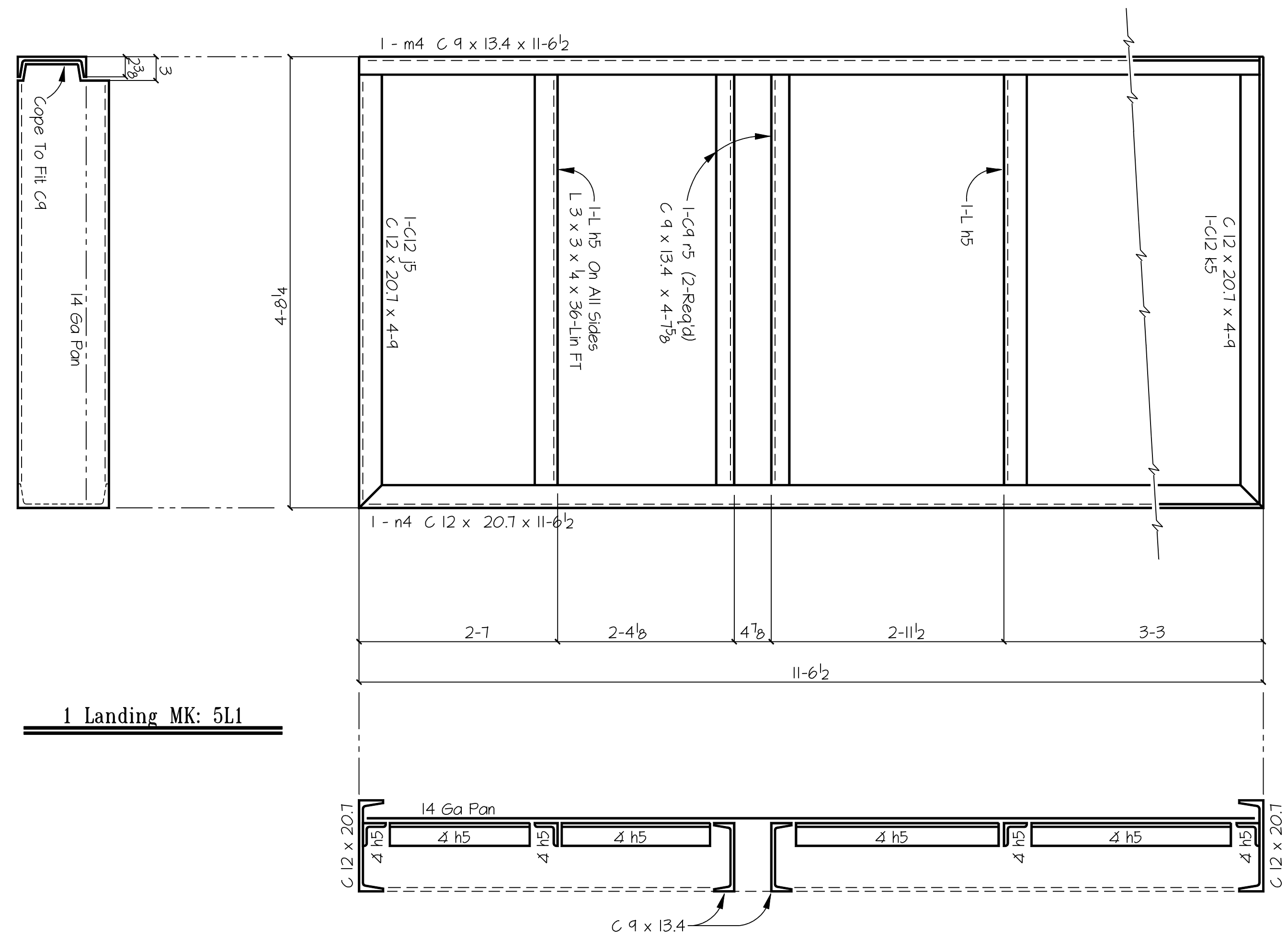
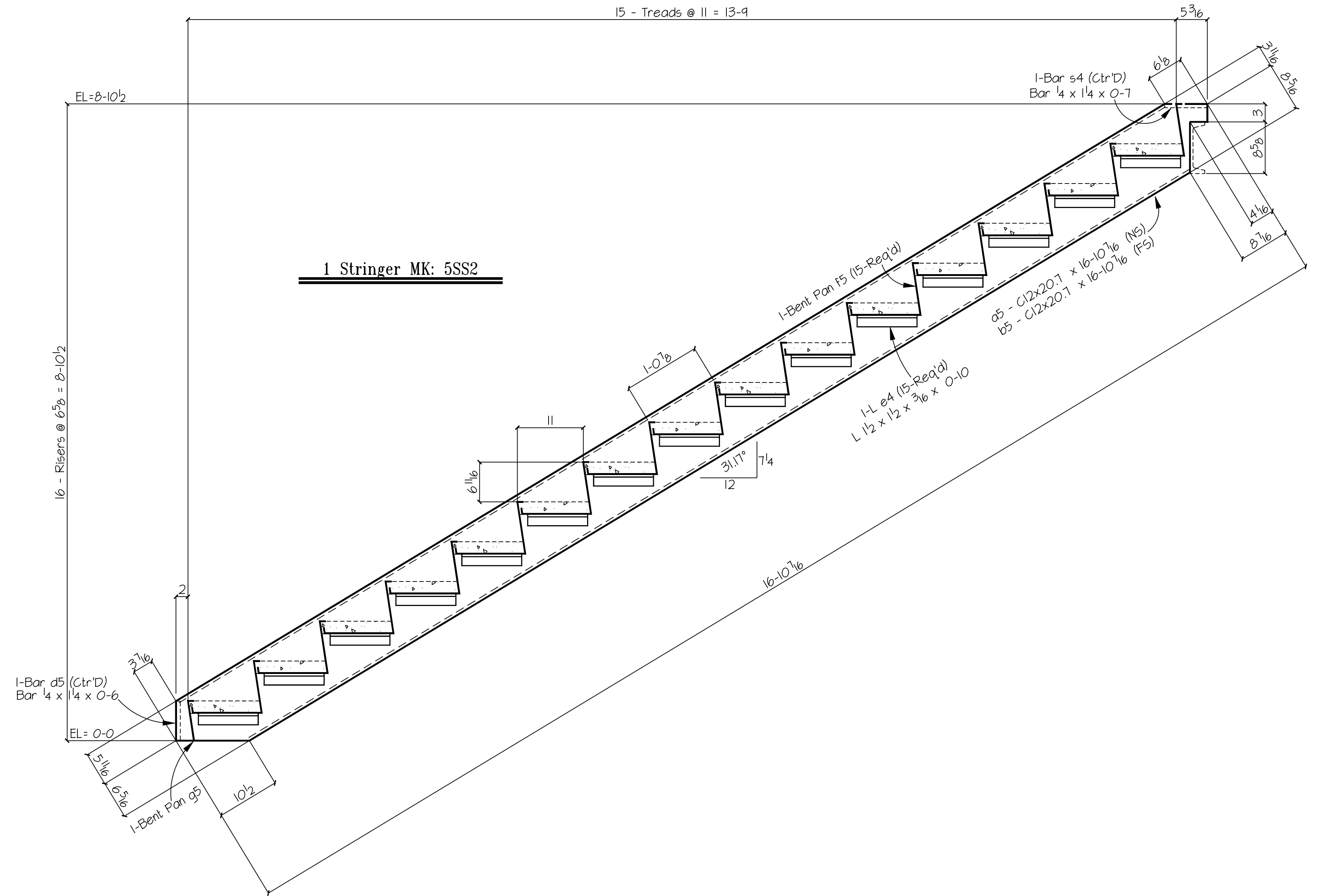
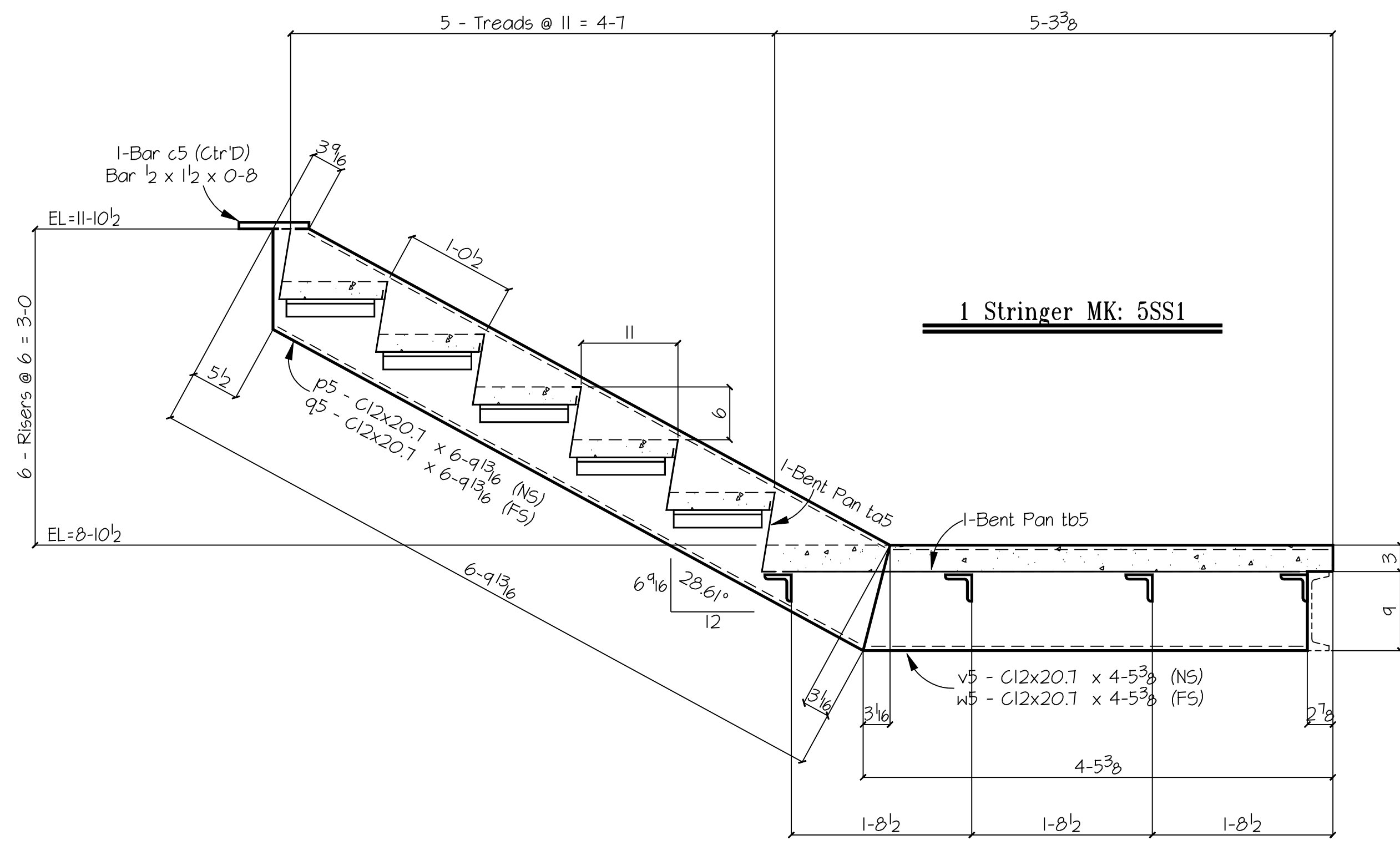

- DESCRIPTION OF REVISIONS MADE TO DRAWING -

1			
2			
3			
4			

REF DWG _____

- UNLESS NOTED OTHERWISE -

1/4"	MATERIAL GRADE SHELL BE	A36	U.N.O.
FILLETS	WF SHAPES	A992	TUBES A500
13/16" Ø	CHANNELS	A992	PIPES A501 or A53
OPEN HOLE	REF SCHEDULE	Item #	SFI 5101
	COATING	One 5/16 Red Oxide Primer	

AWF

DETAILS OF Stair Stringers And Landing

PROJECT AT&T Science Facility

LOCATION ?

CUSTOMER Texas Lutheran University

ARCHITECT ?

ENGINEER ?

DETAIL DR 2-18-08

CHK.R _____

SHOP CODE AT&T Science

SHEET # D5

REV #

FN: atsc-stairs.dwg

